

Signal blowpipe



Specification

Fluid Media

Air, O₂

Operating Parameters

Signal setting: 30 bar ⁺¹⁰
(different setting pressures on request)

Discharge rate: max. 4 l/min

Connection: M12 X 1,5

Order no.:

Air R27125-08

O₂ R27125-12

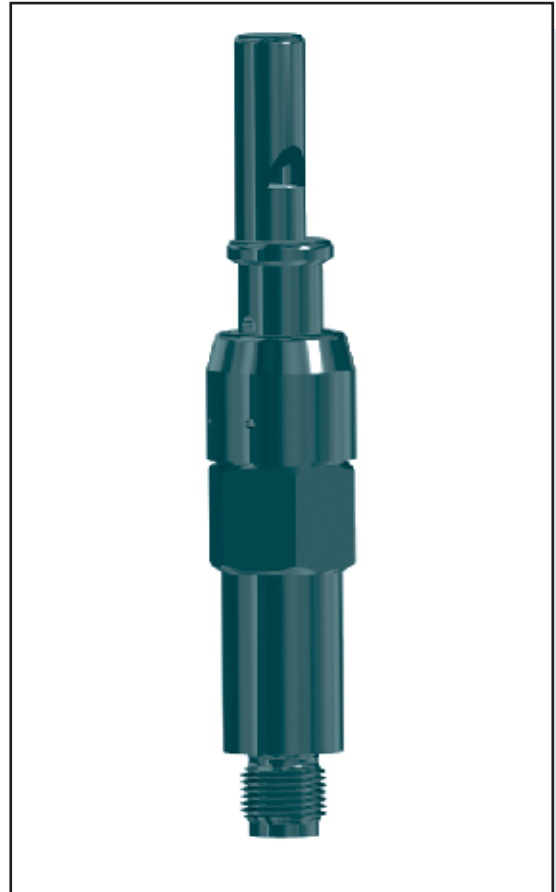

TESCOM EUROPE GMBH & CO. KG

An der Trave 23-25 • D-23923 Selmsdorf • Germany
Tel: +49 (0) 3 88 23 / 31-0 • Fax: +49 (0) 3 88 23 / 31-199
info@tescom-europe.com • www.tescom-europe.com

TESCOM EUROPE is a business unit of the Regulator Division. Trademarks are property of divisions of Emerson Process Management.
12115-09-05 Subject to technical changes

